

User Manual

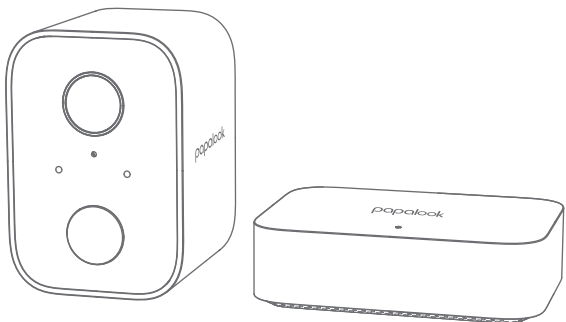

Indoor/Outdoor Wire-free Security Camera
Model: SE

Dear User,
Thank you for purchasing papalook SE.

I. Package Contents

For SE Homebase installation

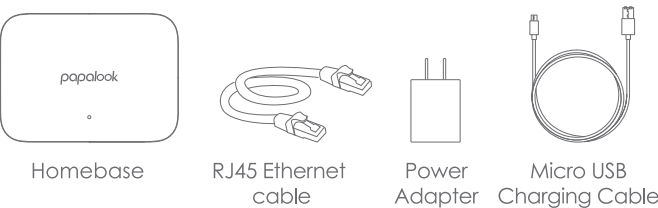

For SE camera installation

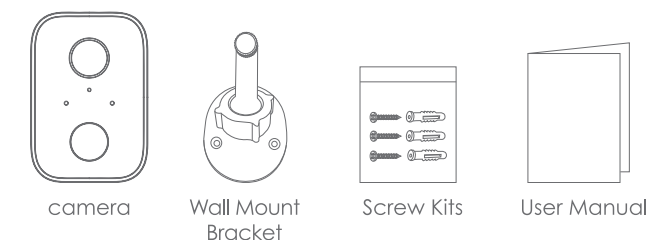

EN-1

2. Product Overview

Homebase

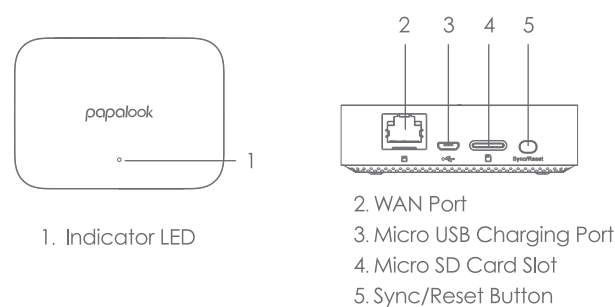

camera

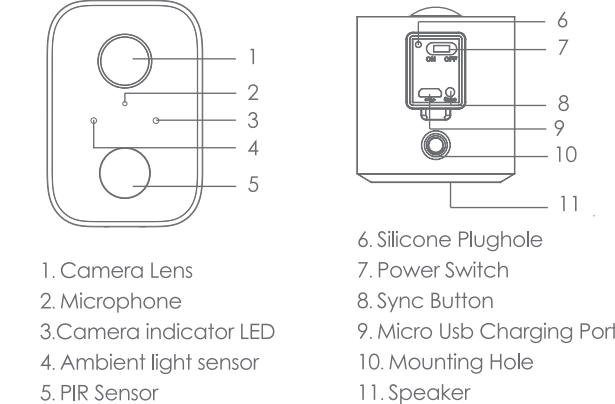

EN-2

3. Power The Camera kit

3-1 The Homebase is powered by a power adapter using the micro USB cable to work.

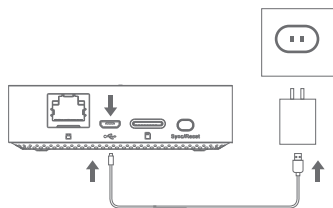

3-2 The SE camera has built-in a rechargeable battery, please use the camera USB cable to connect the camera and the power adapter, then plug the adapter into power outlet (100V-240V) for charging. The camera indicator light will turn solid white when charging.

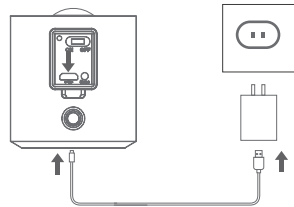

3-3 It requires up to 5hurs for full charging. Once full charging, the white indicator LED will turn off.

EN-3

4. Getting started

4-1 Download the App

Download the "papalook" App from the Apple store (ios) or Google play (Android device) . Sign up for a Papalook account and follow the onscreen instructions to complete setup. (Note: Please make sure that your mobile device OS is ios9.0 or higher, or Android 4.1 or higher.)



4-2 Connect the device

1) Use the RJ45 Ethernet cable to connect the Homebase to Router's LAN port.
2) Plug the adapter into the power outlet to power on the Homebase.The Homebase indicator LED will change from solid red to blink red when the Homebase is ready for pairing. (Note: Need one Router connecting to Internet and need an uplink network with at least 2MB speed.)

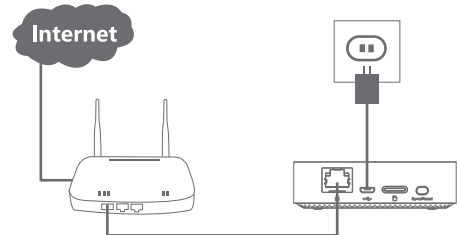

EN-4

4-3 Networking the Homebase

Before connecting the camera, you need connect the Homebase first.

- 1)** Please connect your smartphone and the Homebase to one Router
- 2)** Open "papalook" App, click the top right "+" to add device
- 3)** Select "Base Station", follow the instructions to add the Homebase.

4-4 Networking the Camera

1) Please switch on the camera, then the camera will beep, and the camera indicator LED starts to flash red.If the camera indicator LED does not flash red, please press and hold the sync button for 5s to reset the camera.

2) Next, enter the Homebase interface on the app, click the "+ Add Device" at the bottom, and follow the instructions to add the camera into the Homebase.

3) When the camera successfully pairs to the Homebase, a voice prompt will be heard from the camera and the camera's indicator LED will turn green, while the Homebase indicator light also will turn to solid green.Then the added camera will be displayed on the app.(The Homebase support 4 cameras connecting at most)

4) If the camera could not pair to the Homebase, please add the camera again following the above ①②③ steps.

EN-5

5. Specification

Homebase	
Local storage	Support micro SD card (Max capacity up to 128G)
Sync/Reset	Press and hold for 5s, Homebase will be reset, and enter the status for waiting for pairing
Suitable for	Indoor installation
Camera	
Power ON/OFF	Turn on/off the camera by the power on/off switch
Sync	Press and hold the button for 5s to reset the device and enter the status for waiting for pairing
Suitable for	Outdoor/Indoor installation
Video Quality	1080P Full HD(1920 x 1080)
Night Vision	Black/white
Field of View	120° Wide viewing angle
Power Options	Rechargeable Battery Powered
Charging input	Support DC 5V/2A
2-Way Audio	Support hear & talk (Built-in mic and speaker)
Video Storage Location	Micro SD Card in Homebase & Cloud Storage (optional)
Smart Detection	PIR Motion Detection, Up to 8 m (26 ft)
Wi-Fi	2.4G Wi-Fi (IEEE802.11b/g/n) Only
Weatherproof	IPX65

EN-6

Customer Service

- 1-Year Limited Warranty
- Lifetime Technical Support
- Support@papalook.com

For more information, please visit our official website
www.papalook.com

Your valuable comments and suggestion on improving
papalook products are welcomed!

6. Indicator LED status

Homebase indicator LED	
Solid red	Power on and activating
Quick flashing red	Ready for Internet pairing
Quick flashing green	Ready for connecting to the Network Server
Solid green	Connected to the Network Server successful
Solid yellow	Device upgrading
Camera indicator LED	
Red blinks quickly	Power on and standby for configuration
Green blinks quickly	Connecting to the Network
Solid green	Connected to the Network and working normally
Yellow blinks slowly	Device upgrading
Solid white	Charging

7. Installing Camera

The camera can be mounted both indoors and outdoors.

1) Drill or drive the installation tools accessory screws into the wall. If it's a stone wall, then requires screw anchor.

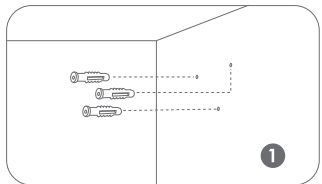

EN-7

2) Screw the mounting base into the wall.

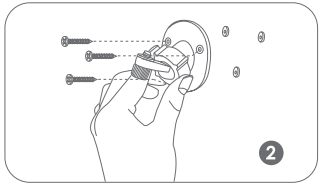

3) Install the camera on the mounting bracket and adjust the camera angle.

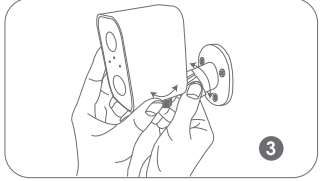

4) Lock the mounting base on it's plate.

Note: Recommend mounting height for 2-3meter.

Important introduction for reducing false notification as follows:

- 1)** Please do not install the camera under strong light.
- 2)** Please install the camera out of the heavy traffic road at 10 meters.
- 3)** Please do not install the camera opposite the mirror.
- 4)** Please do not install the camera around the air vents, humidifiers, and heating vents.
- 5)** Please do not install the camera on the wireless interference area which will affect the stability of the connection.

EN-8

8. Q&A

Q: The Homebase can not power on.

A: 1)Please make sure the power adapter is connected to the power supply.
2)When the Homebase indicator LED up which means the Homebase power on.

Q: The Homebase can not be searched.

A: 1) Make sure the Homebase is power on.
2) Press the Sync/Reset for 5 seconds and waiting for the indicator light flashes, then the Homebase enter to matching model.

Q: The SE camera can not power on.

A: 1) Make sure the camera is power on.
2) Maybe the camera battery is dead, you can charge it by a smartphone adapter with micro USB cable, then power on the camera.

Q: The Homebase can not connect to the wifi.

A: 1) Please check your WIFI is 2.4G, the camera does not support 5G WIFI.
2) Please make sure the smartphone and the Homebase connected with same Wi-Fi.
3) Please make sure do not have wireless interference when the Homebase during connecting.

Q: The micro SD card cannot be recognized.

A: 1) Please make sure the Homebase online and the micro SD card installed in the Homebase micro SD card slot.
2)The micro SD card must be Class 10 or higher.
3)The only way to watch the contents of the micro SD card is by using the mobile phone which is already connected to Papalook Homebase.

EN-9



CAUTION

RISK OF EXPLOSION IF BATTERY IS REPLACED BY AN
INCORRECT TYPE DISPOSE OF USED BATTERIES
ACCORDING TO THE INSTRUCTIONS

RECYCLING

This product bears the selective sorting symbol for Waste electrical and electronic equipment (WEEE). This means that this product must be handled pursuant to European directive 2012/19/EU in order to be recycled or dismantled to minimize its impact on the environment.
User has the choice to give his product to a competent recycling organization or to the retailer when he buys a new electrical or electronic equipment.



DC voltage



This device complies with part 15 of the FCC Rules. Operation is subject to the following two conditions:(1) This device may not cause harmful interference, and (2) this device must accept any interference received, including interference that may cause undesired operation. Any changes or modifications not expressly approved by the party responsible for compliance could void the user's authority to operate the equipment.
Note: This equipment has been tested and found to comply with the limits for a Class B digital device, pursuant to part 15 of the FCC Rules. These limits are designed to provide reasonable protection against harmful interference in a residential installation. This equipment generates uses and can radiate radio frequency energy and, if not installed and used in accordance with the instructions, may cause harmful interference to radio communications. However, there is no guarantee that interference will not occur in a particular installation. If this equipment does cause harmful interference to radio or television reception, which can be determined by turning the equipment off and on, the user is encouraged to try to correct the interference by one or more of the following measures:
-Reorient or relocate the receiving antenna.
-Increase the separation between the equipment and receiver.
-Connect the equipment into an outlet on a circuit different from that to which the receiver is connected.
-Consult the dealer or an experienced radio/TV technician for help.
The device has been evaluated to meet general RF exposure requirement. The device can be used in portable exposure condition without restriction.